

A Walkable Town:

Adapting for Parry Sound's Future Through Active Living Revitalization

October 7th 2024 | Jenna Neilson

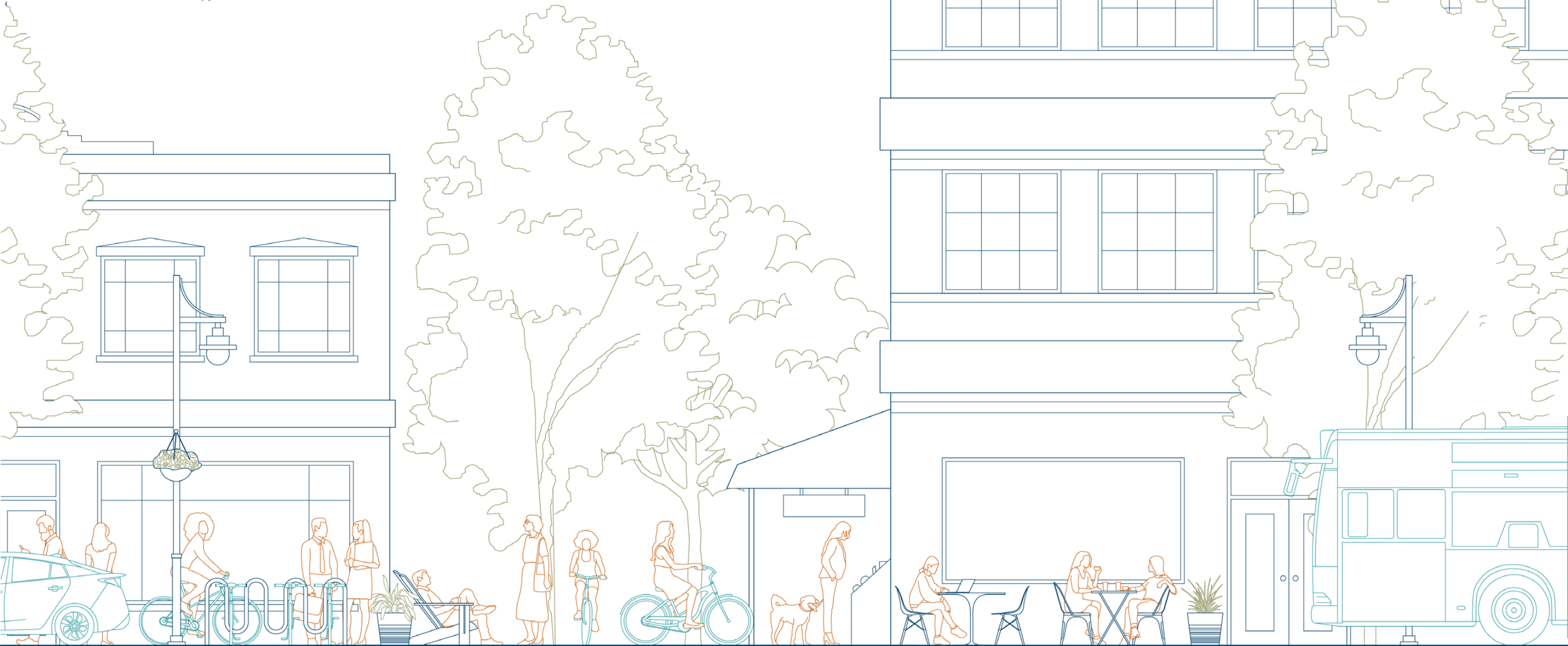

How can Parry Sound's development become less reliant on cars and encourage more active living?



City at the Scale of Human

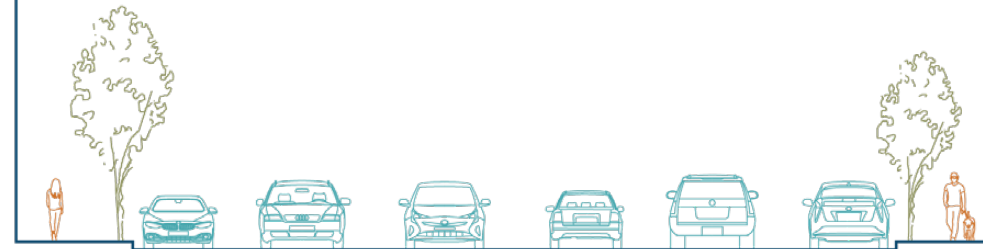

City at the scale of a Car

3 Scales of Development



The Town



The Waterfront



The Streets

Walkable Neighbourhoods

Walkable Neighbourhoods



Active Transit



Mixed Use

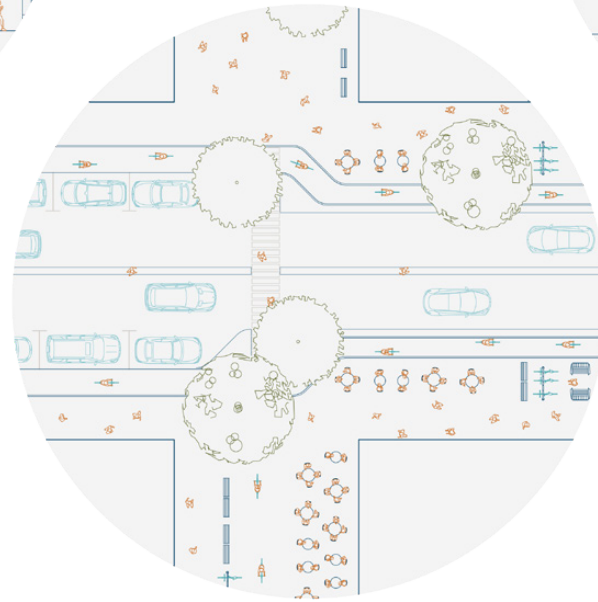

Pedestrian First



Public Transit



Social Community

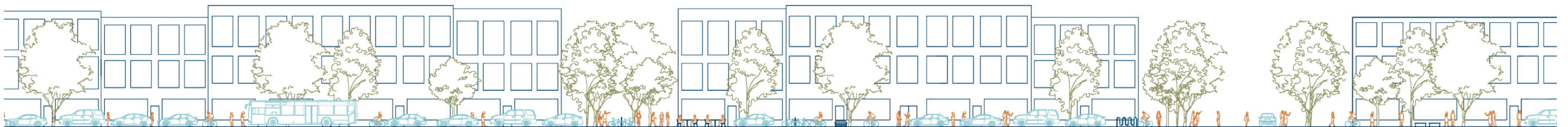

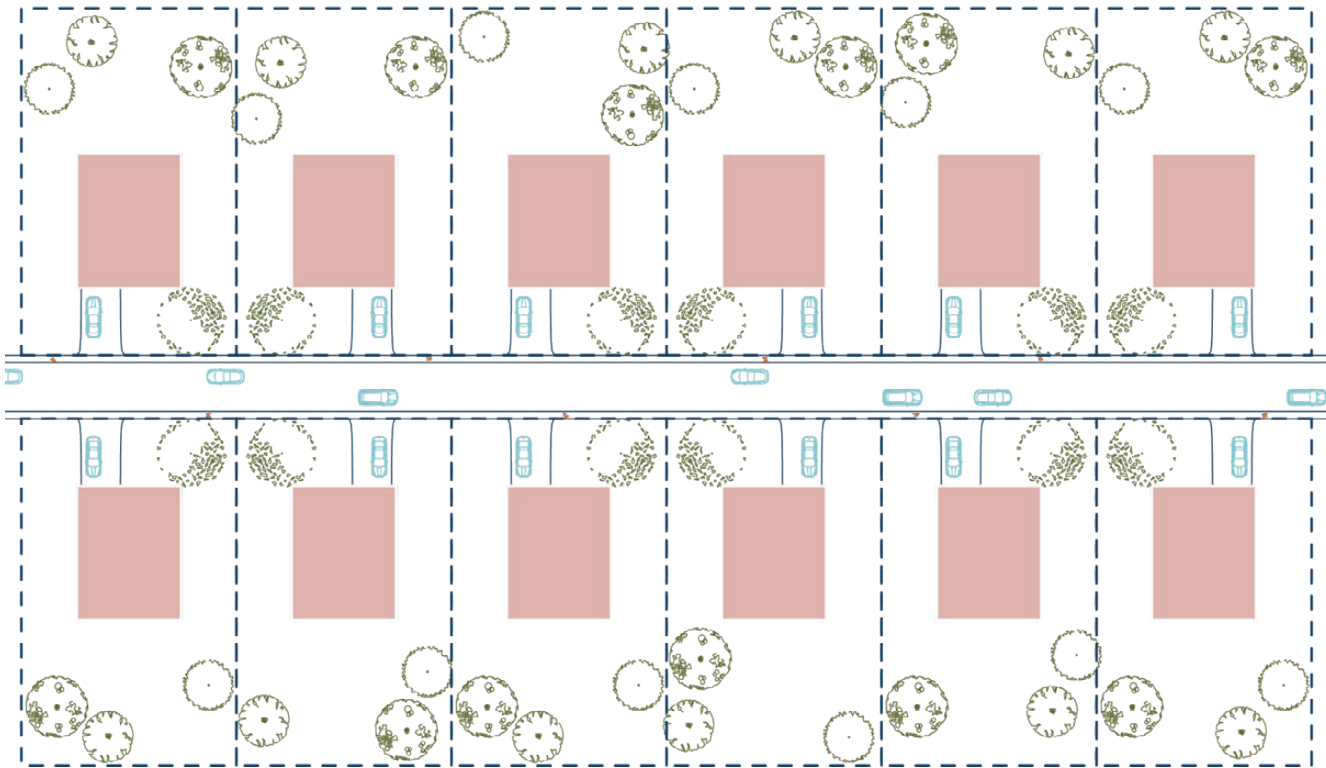

Typical residential development - 3.8 Acres
12 Lots with 2 storey house and yard, about 48 residents

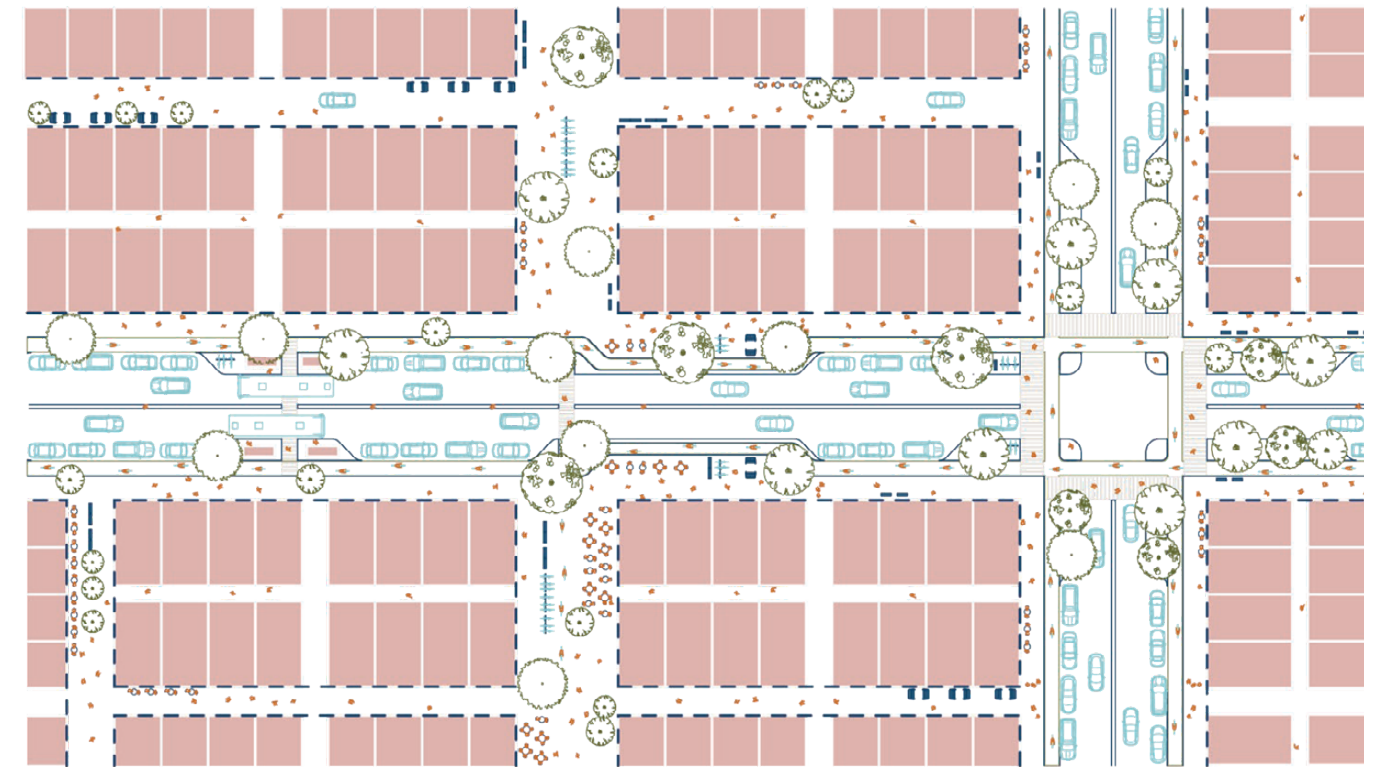

Dense residential mixed use development - 3.8 Acres
about 8, 3 Storey buildings, mixed use and public spaces, over 280 residents



Waterfront Site

Parry Sound Waterfront

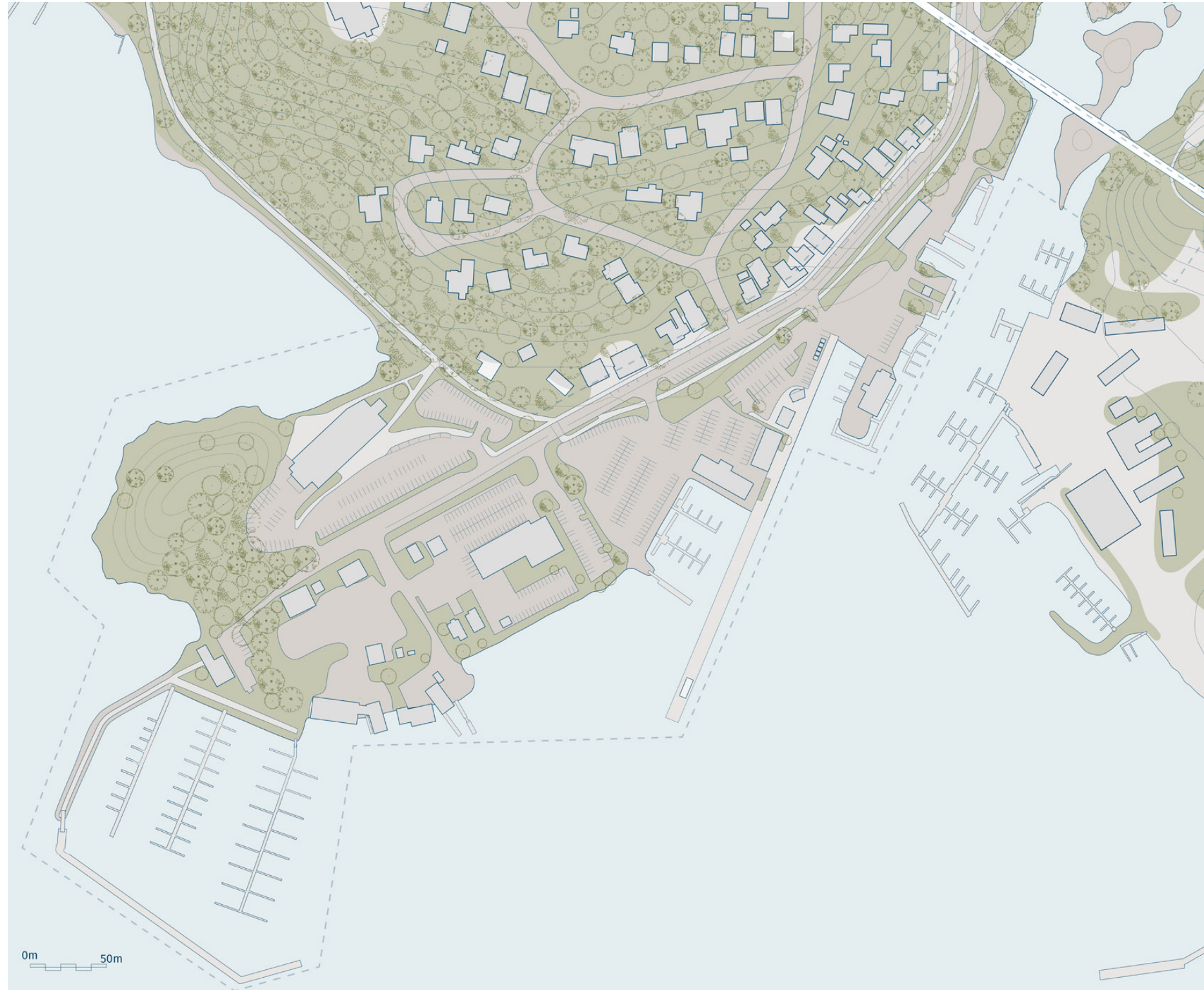



Waterfront Trail



Stockey Center/Bobby Orr Hall of Fame



Service Ontario



Big Sound Marina



M.V. Chippewa III Cruise



Island Queen Cruise



Great Lake Cruises

Urban Design Guidelines



New Waterfront Design

10 Mixed-Use Residential Buildings; 2 and 3-storeys

- 53 Commercial units
- 153 Dwellings; 1,2,3 Bedroom Units; About 460 Residents
- 3 Parkades; 4 storeys
- 840 Parking Spaces

Neighbourhood Hub; 4 storeys

- Grocery Store, Clinic, Cafe, Gym and Daycare
- Offices, Meeting Rooms, Event Rooms, Gallery and Co-working Spaces

Public Spaces etc.

- 96 Additional Public Boat Slips
- 4 Additional Shop Kiosks
- 4 Market Pavilions
- 2 Nature Parks
- Public Sauna and Plunge Pools
- Public Wading Pool/Ice Rink
- Neighbourhood Square
- Dog Park
- Footbridge below the Trestle Bridge
- Pedestrian Streets and Bay Street redesign

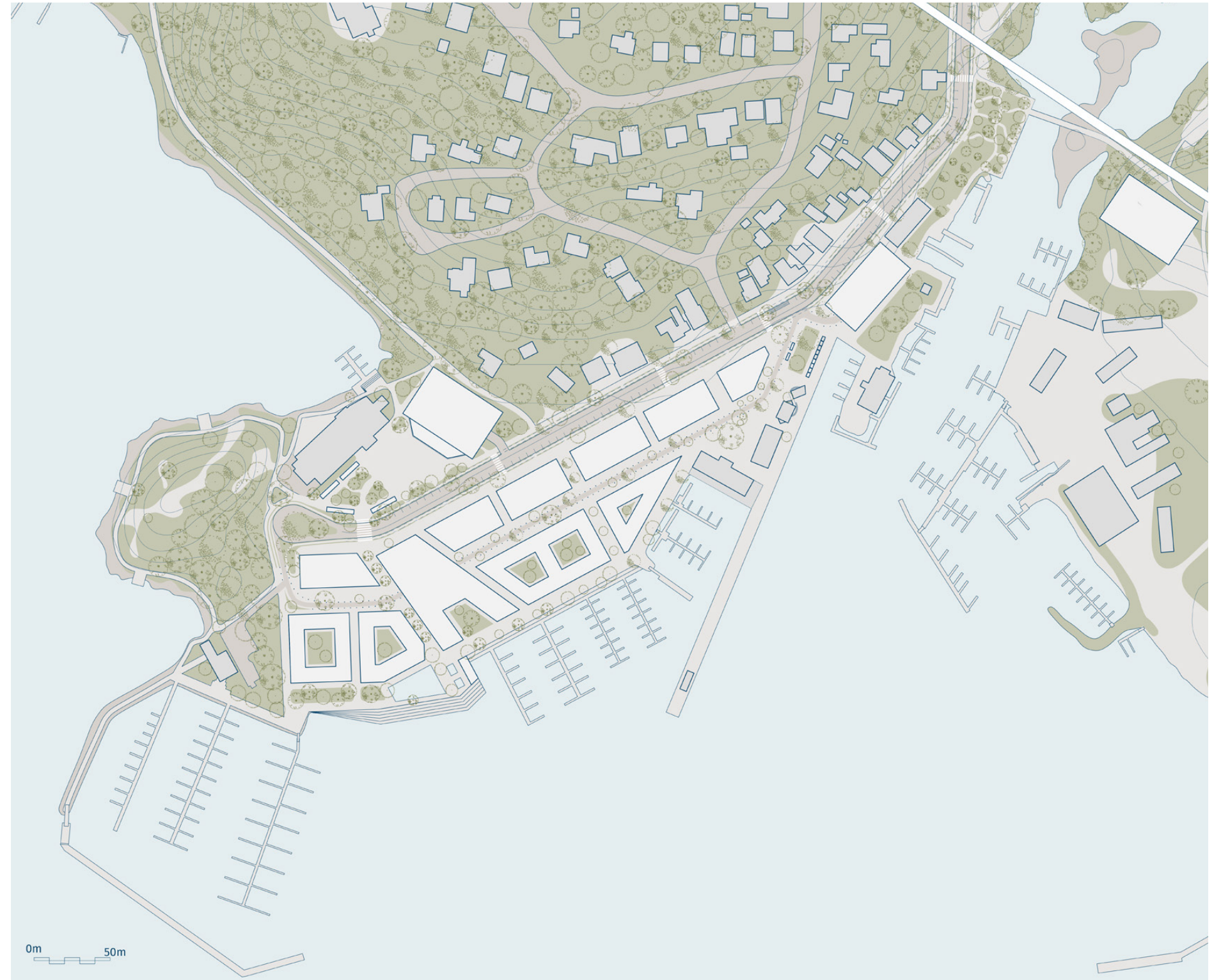

New Waterfront Design



New Waterfront Design



New Waterfront Design

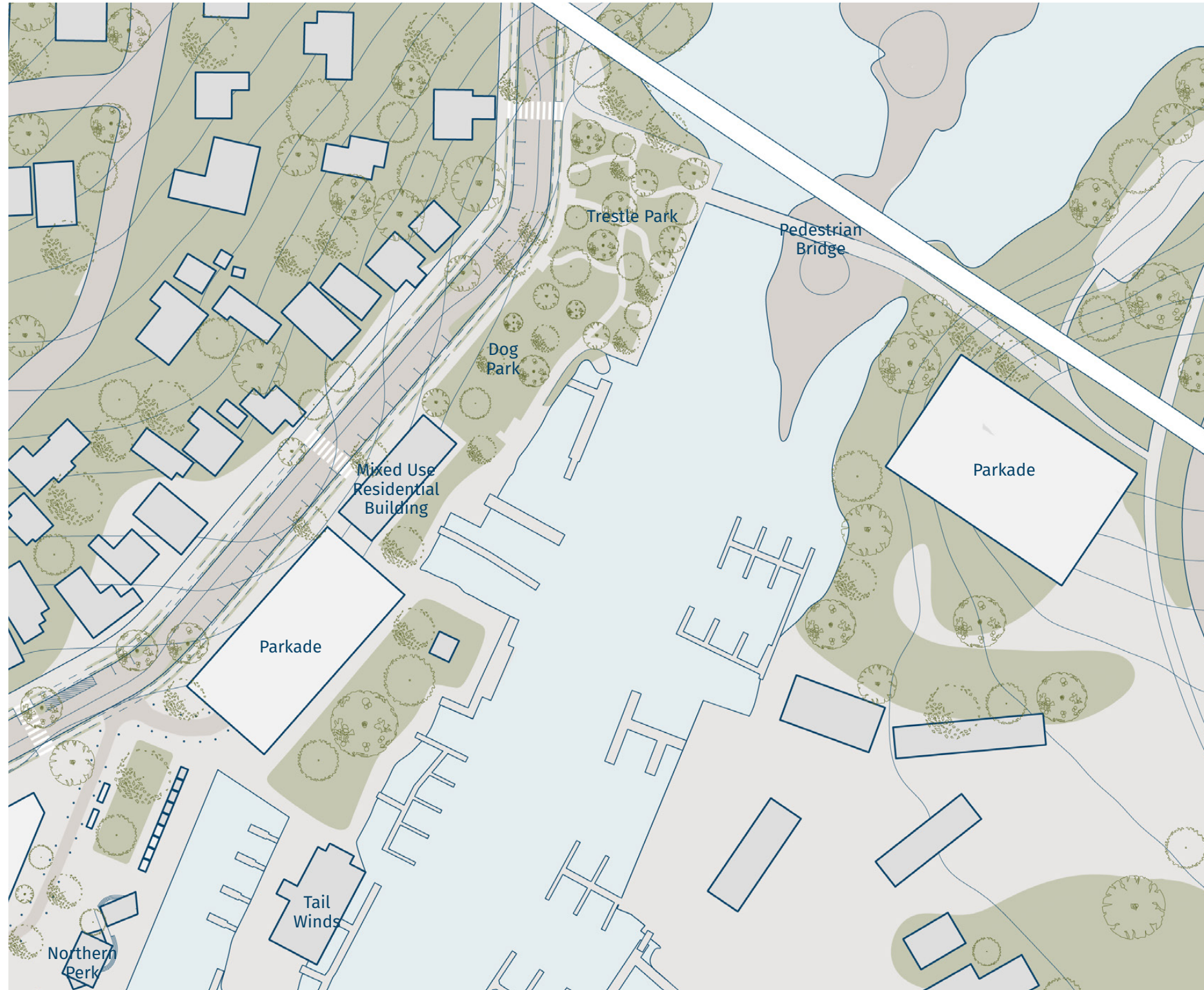

Building Massing



PARKING COMMERCIAL DWELLING COMMUNITY

Building Types

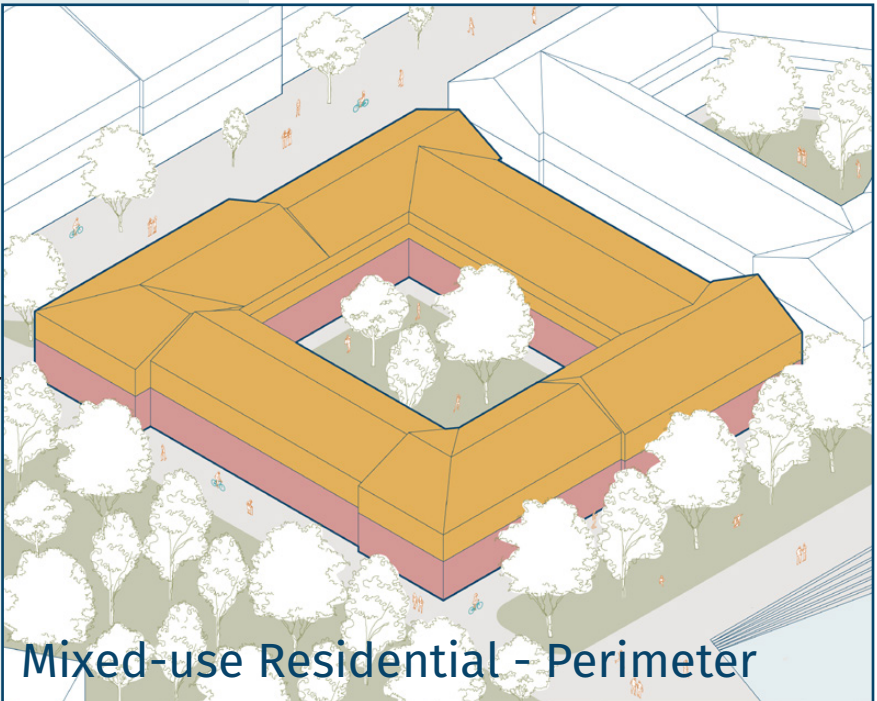
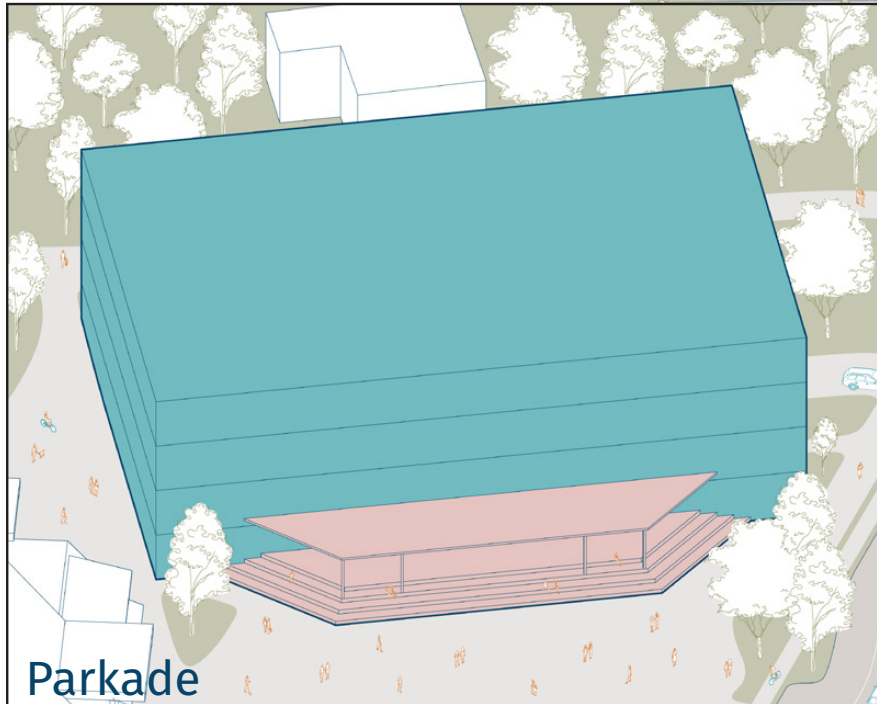
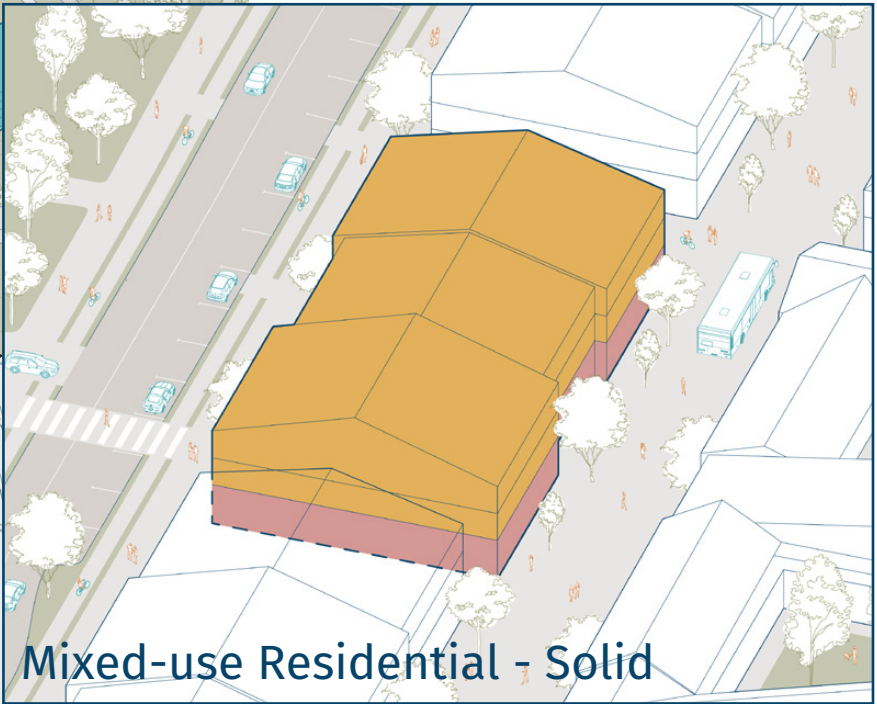
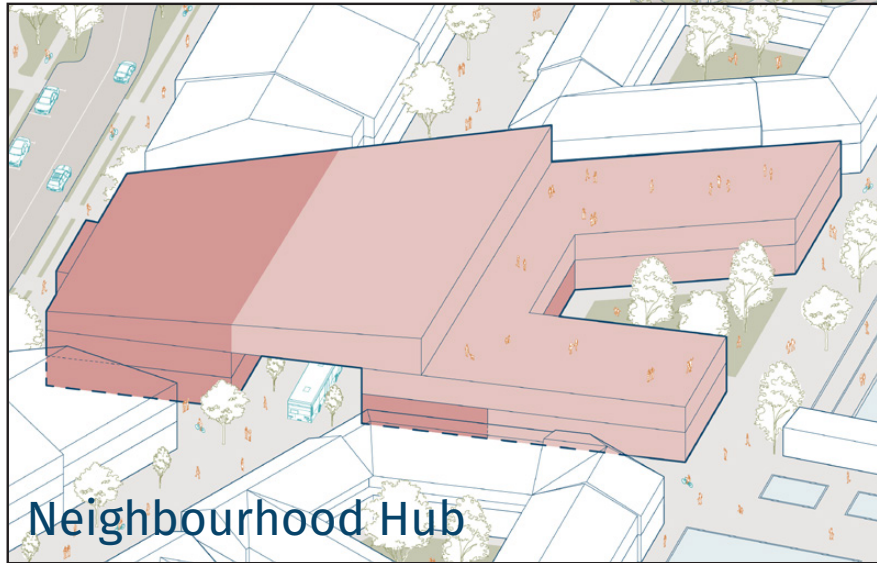
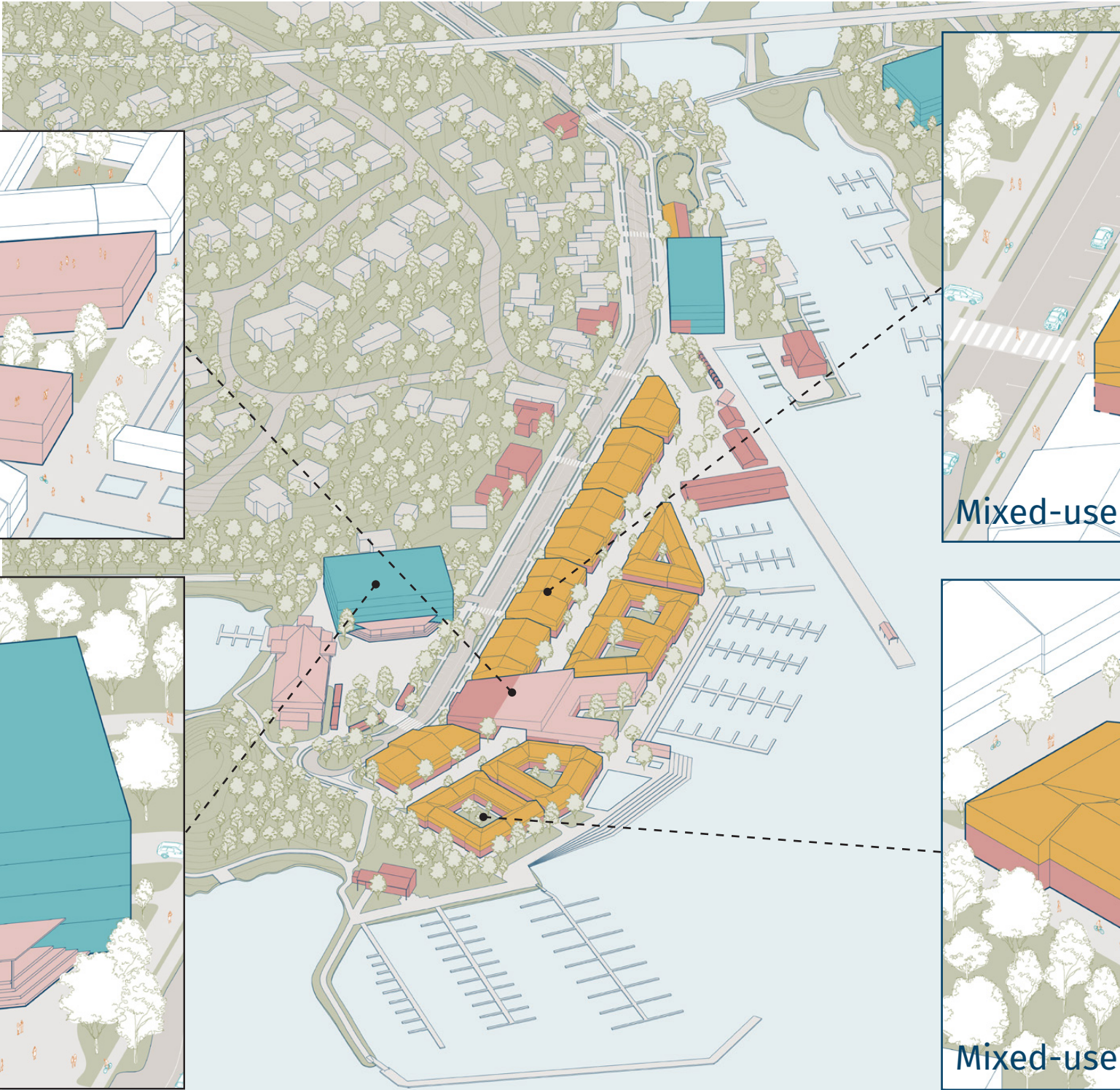

PARKING COMMERCIAL DWELLING COMMUNITY

Neighbourhood Hub



Sample Neighbourhood Hub Elevation

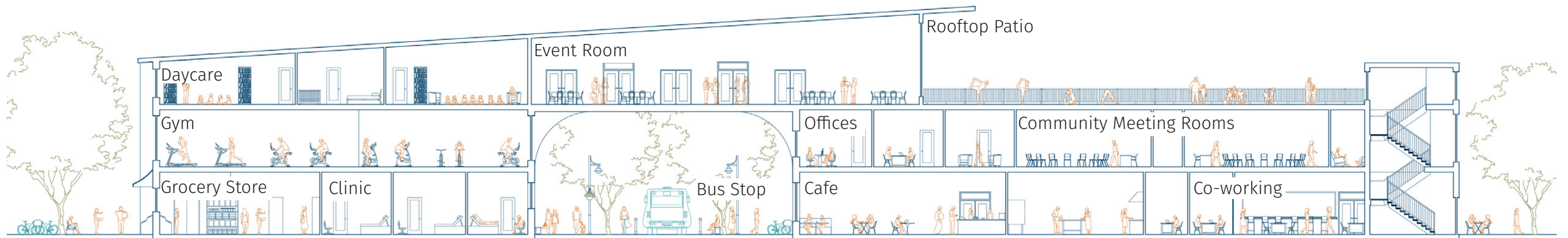

Sample Neighbourhood Hub Section

Parkade

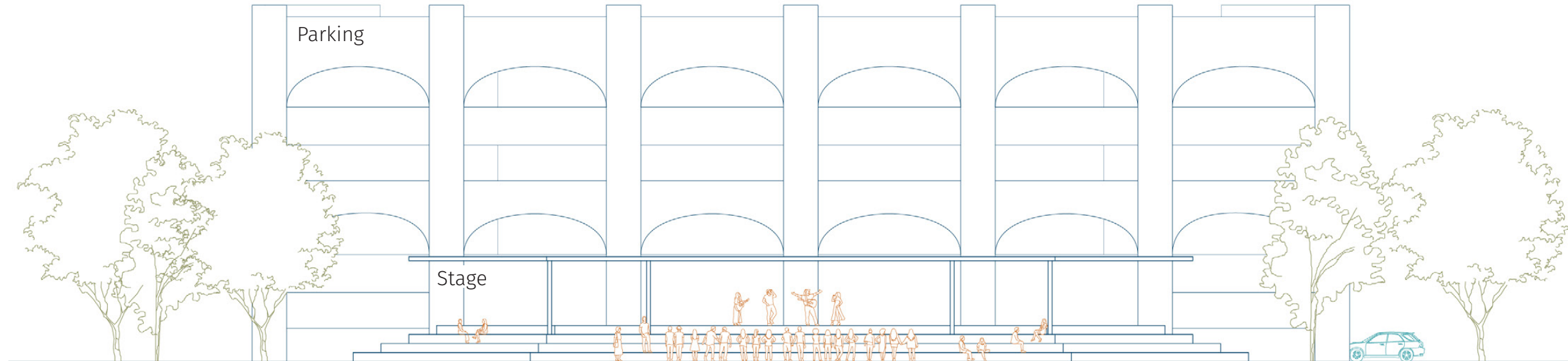

Sample Parkade Elevation

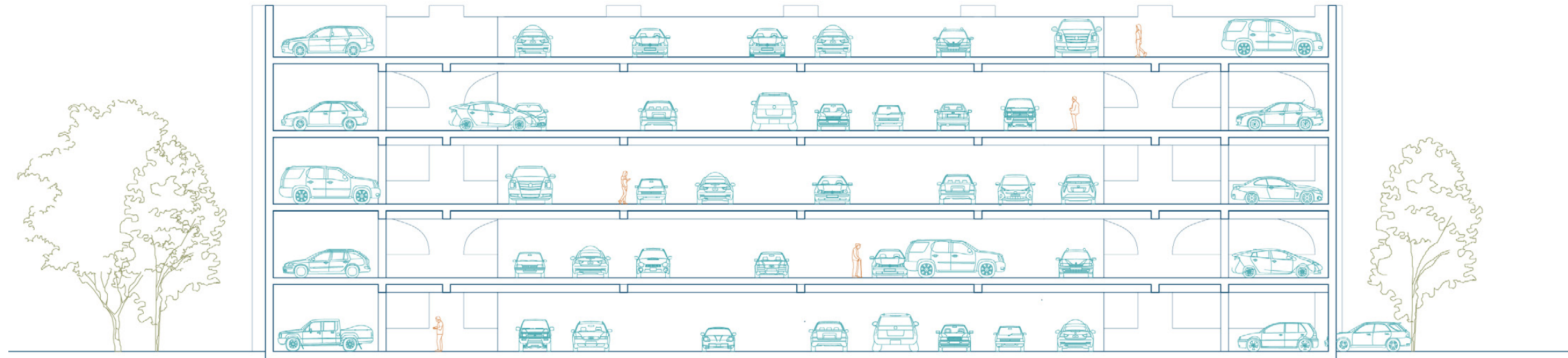

Sample Parkade Section



Residential Blocks



Sample Solid Block Elevation

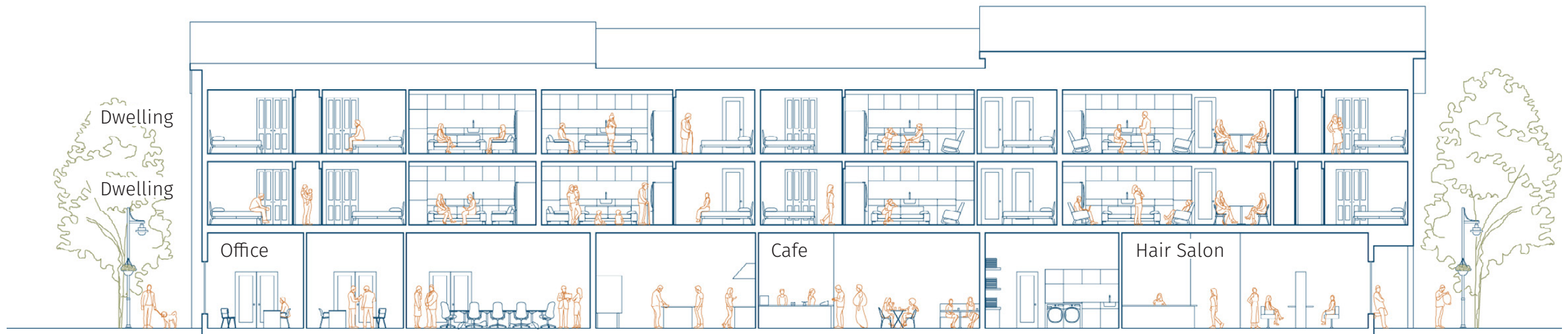

Sample Solid Block Section



Bay Street - Public Spaces

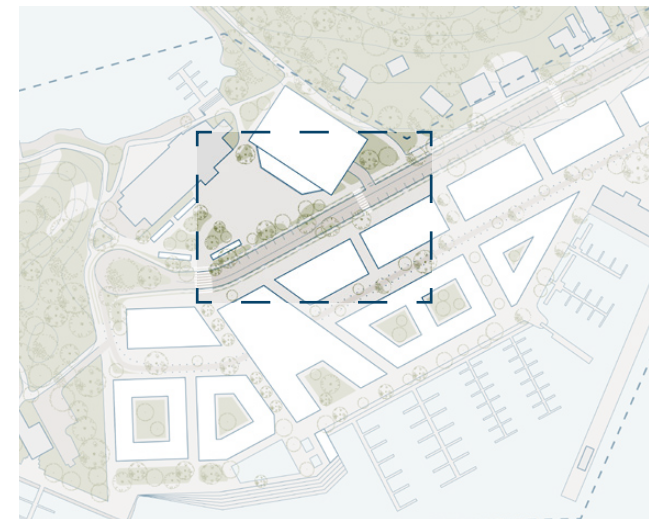
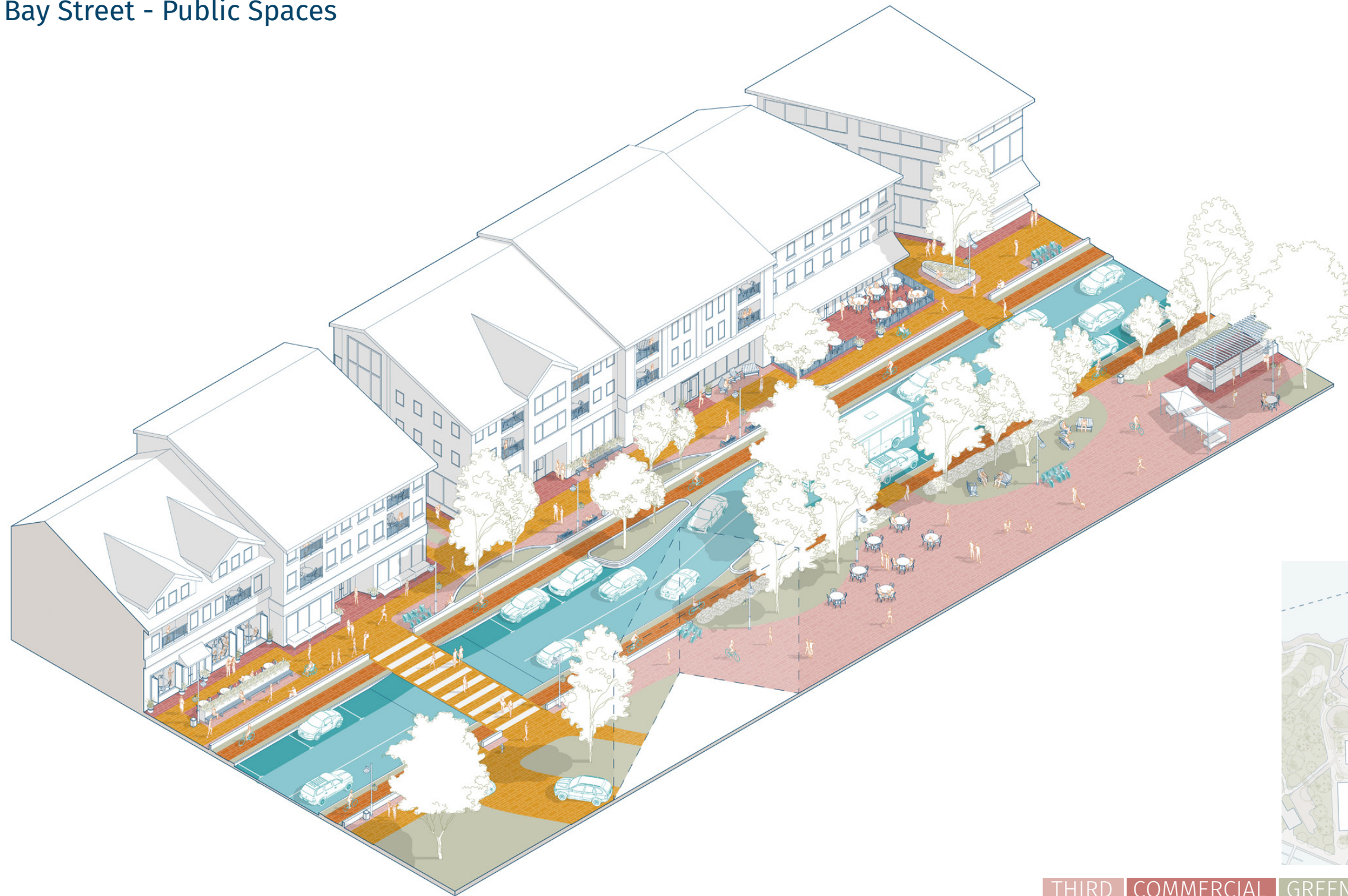

THIRD COMMERCIAL GREEN WALK BIKE PARK DRIVE



Bob's Point Boardwalk Lookout

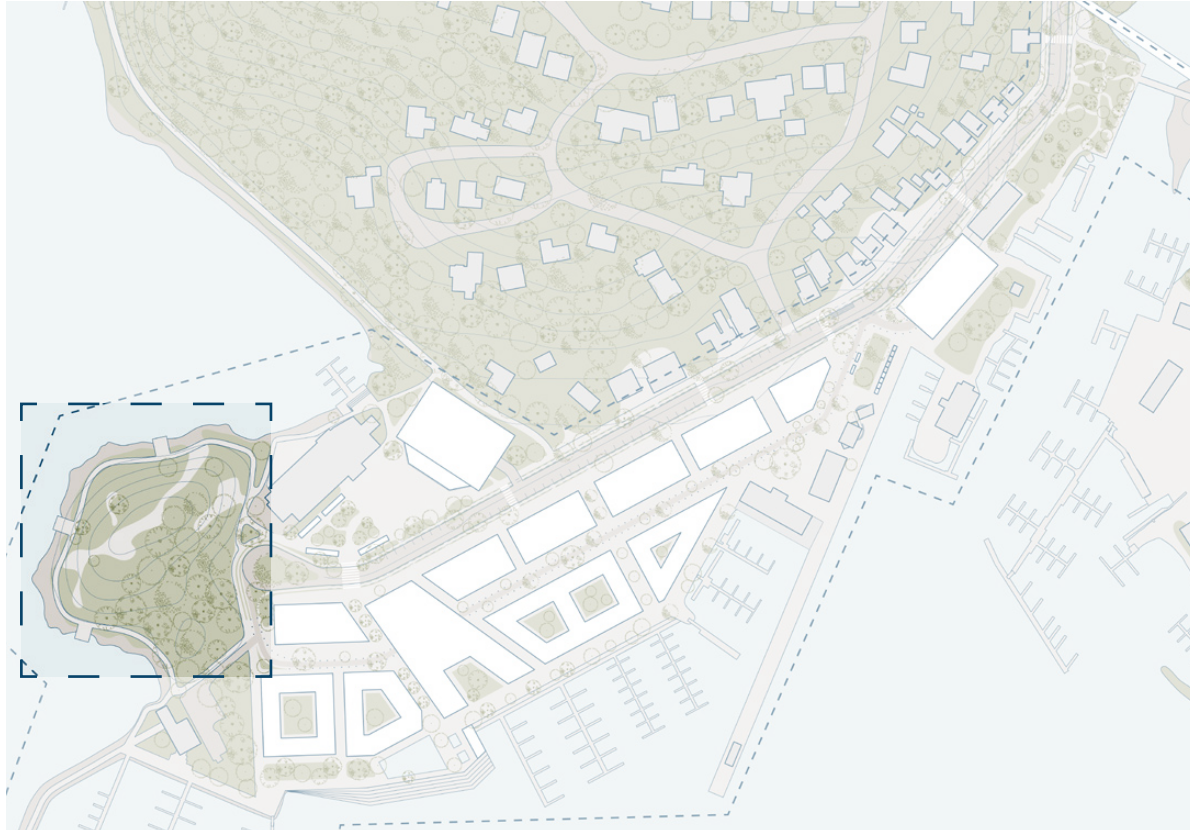

Water Sports Dock

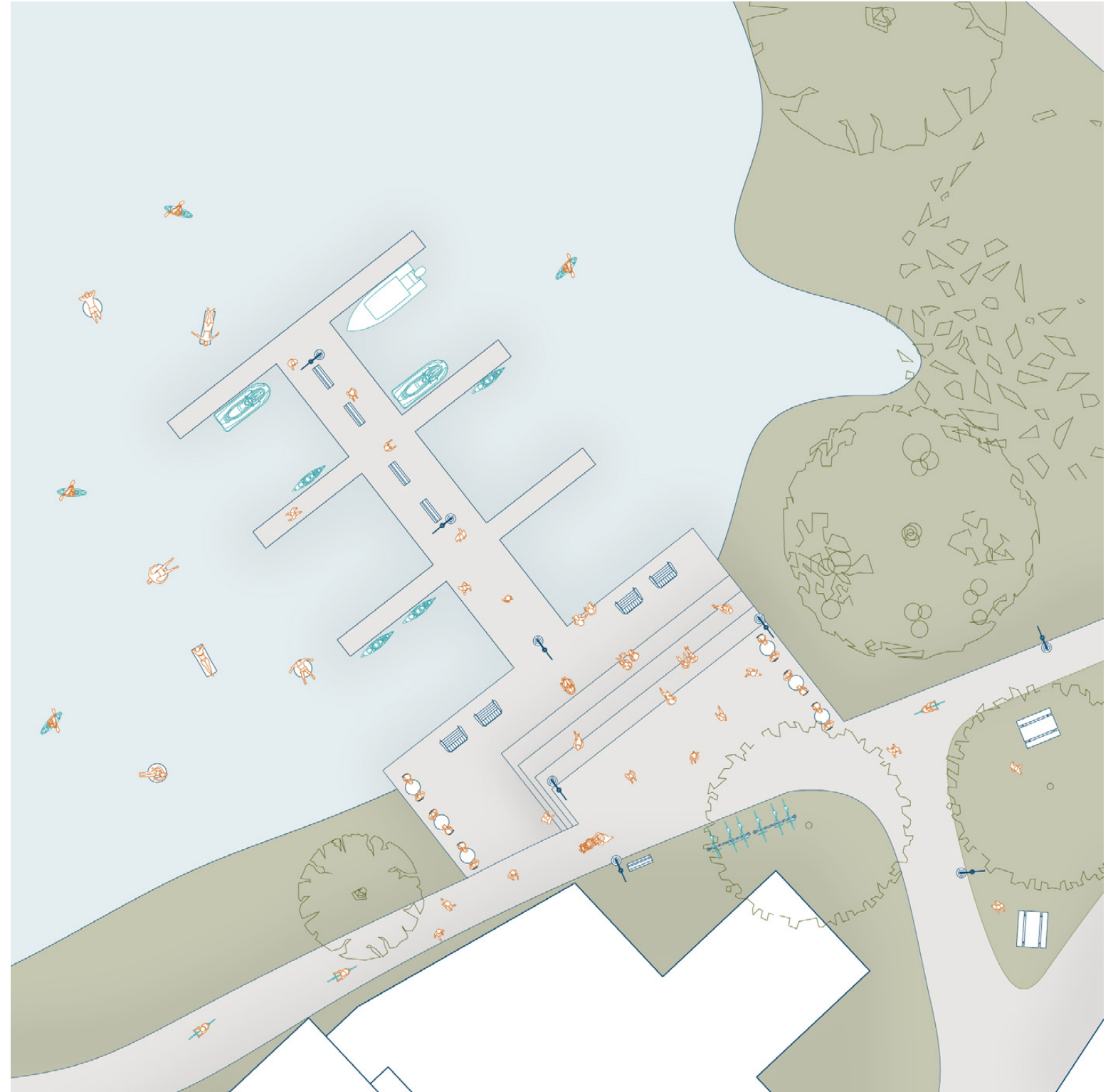
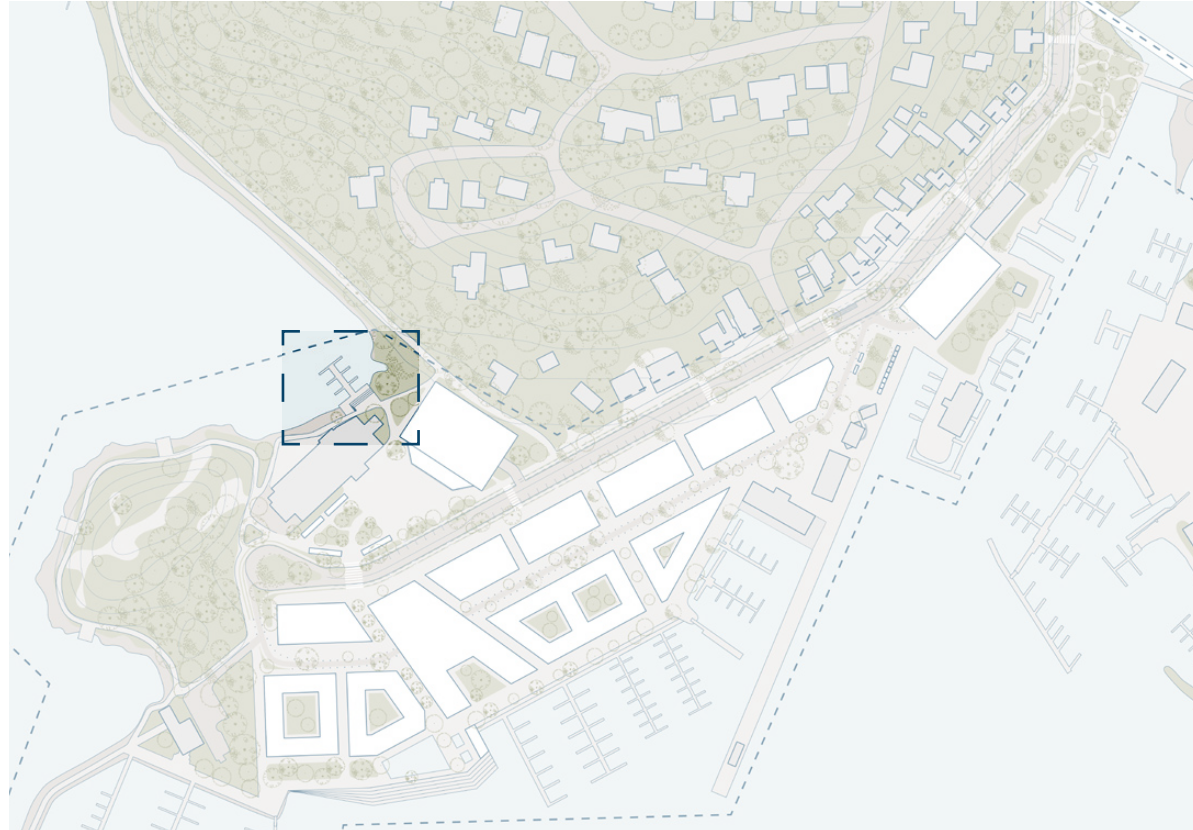

Neighbourhood Market

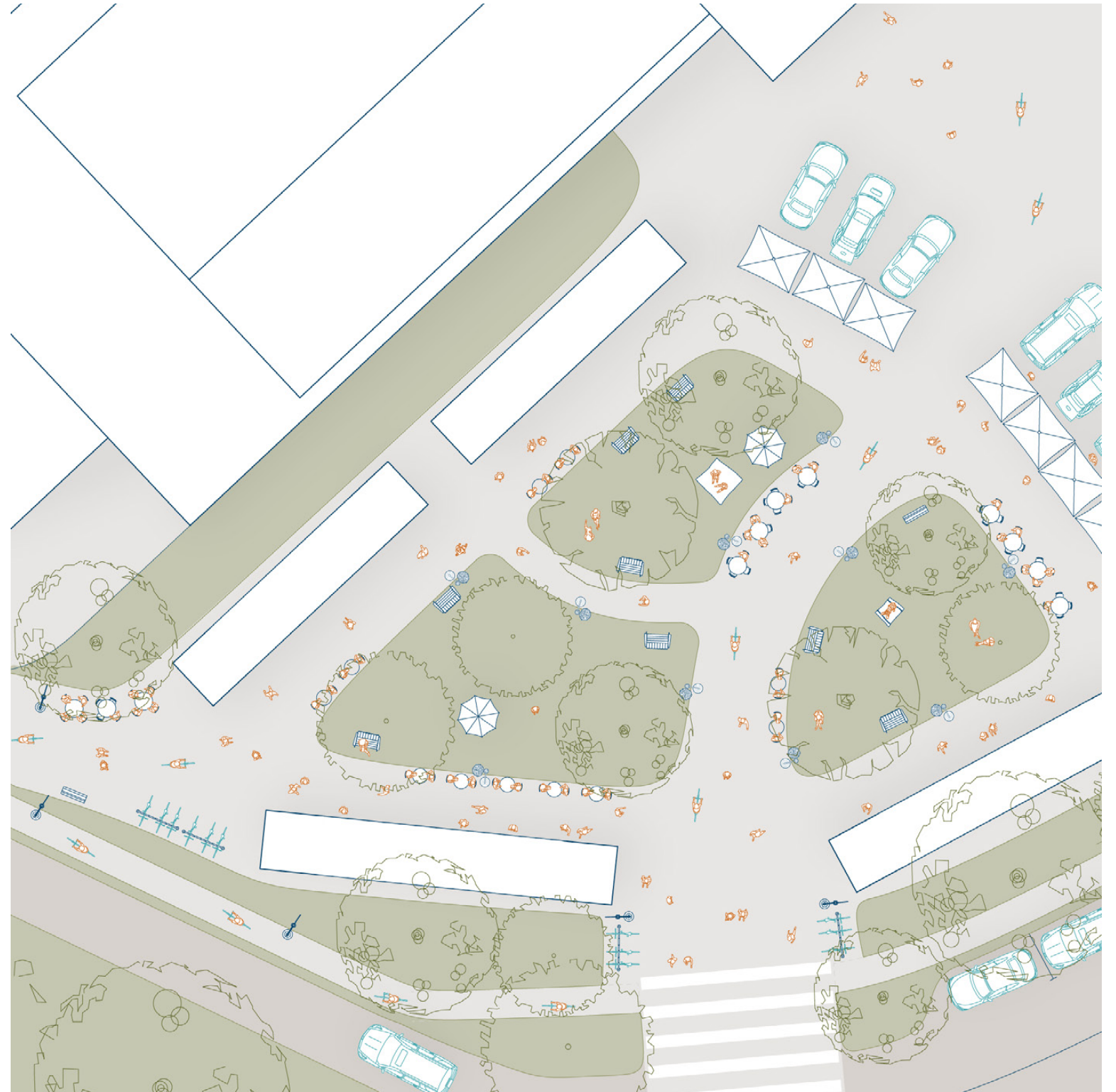
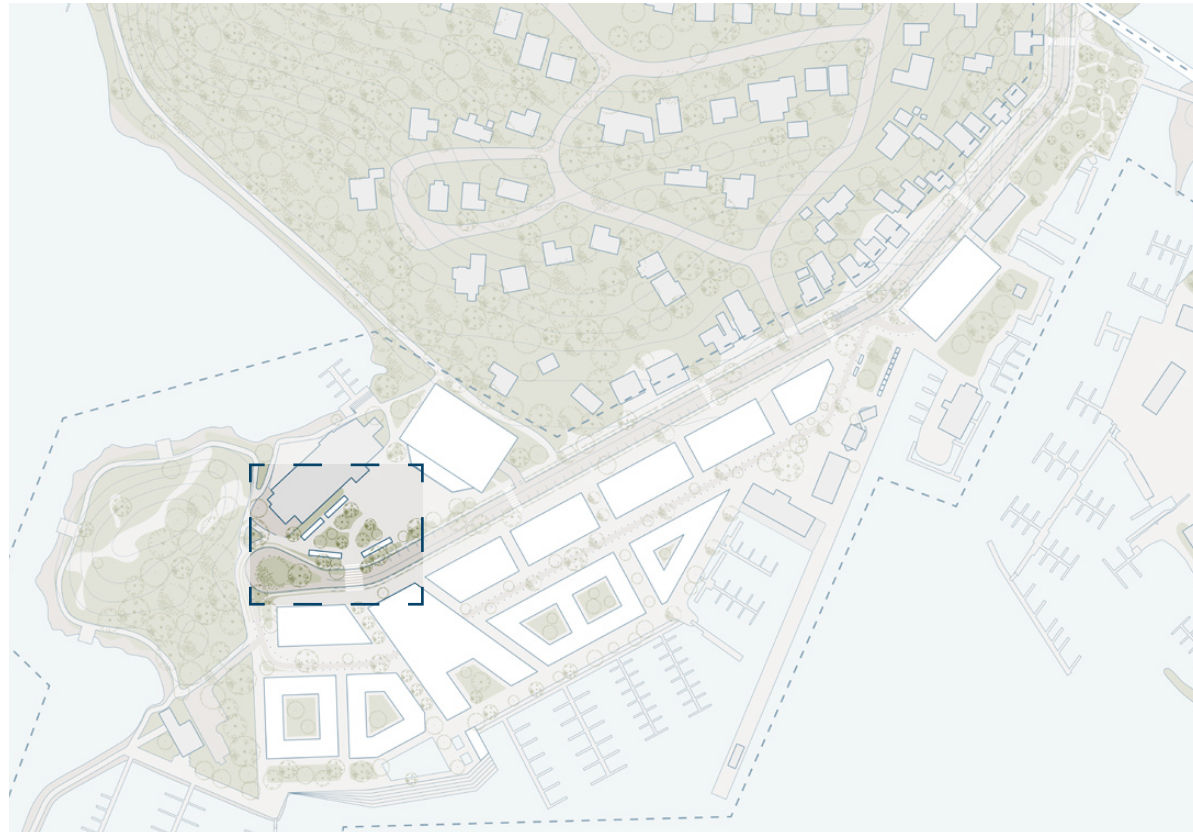



Public Pools and Sauna/Winter Skating Rink

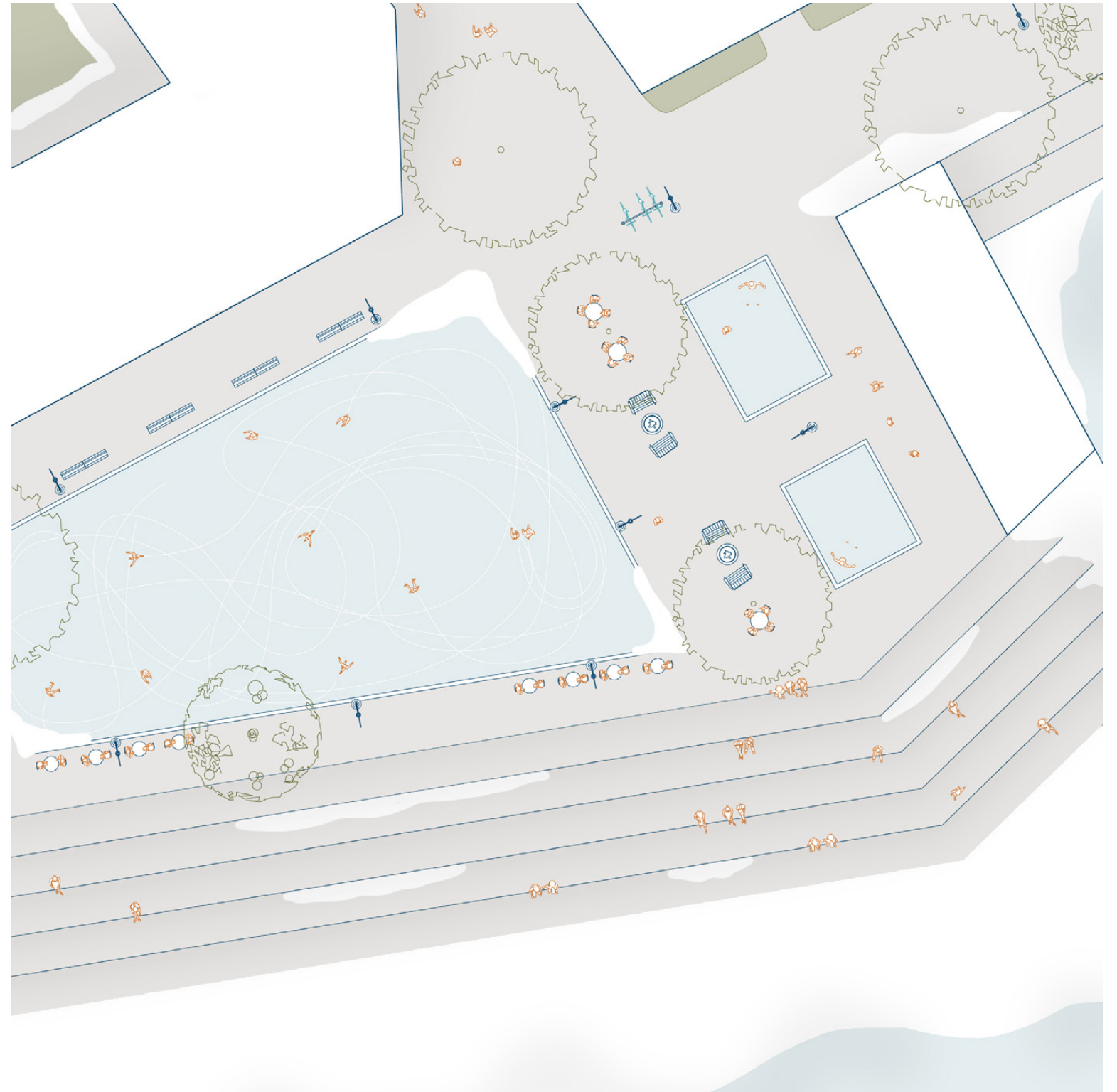
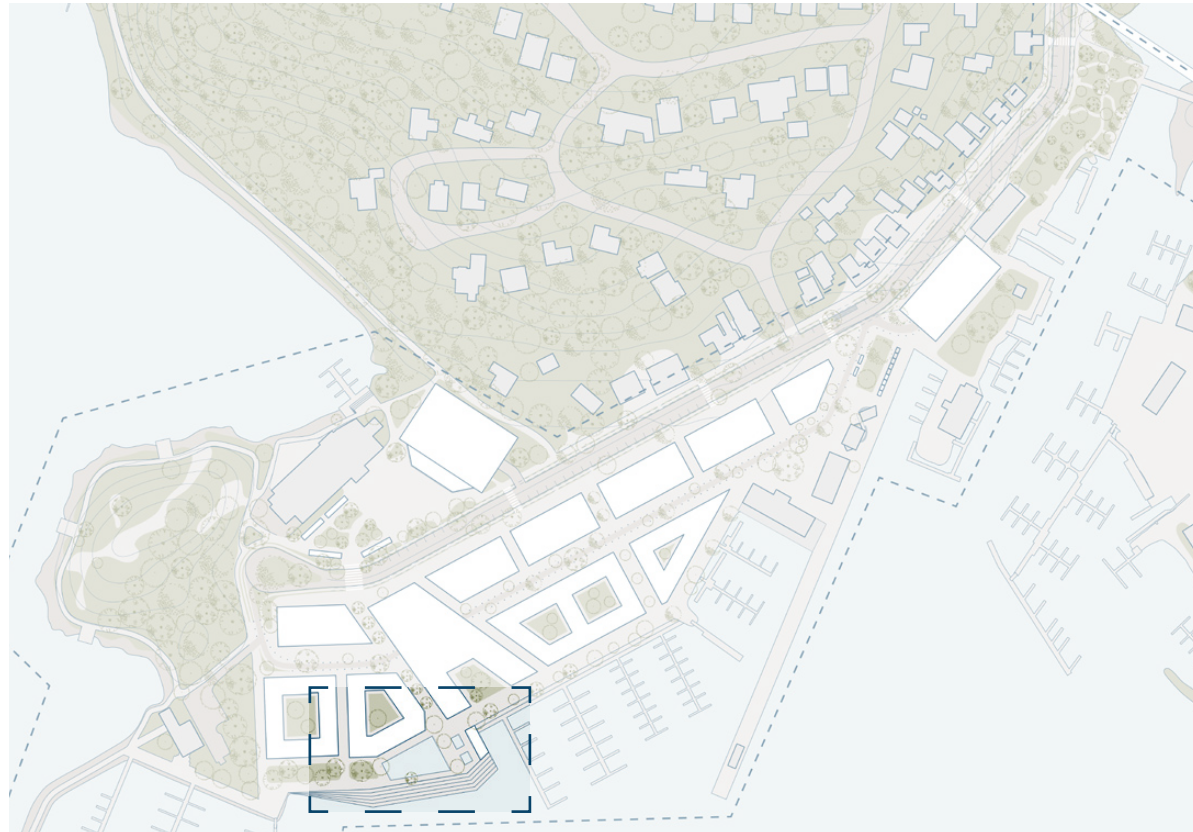





Trestle Park and Dog Park

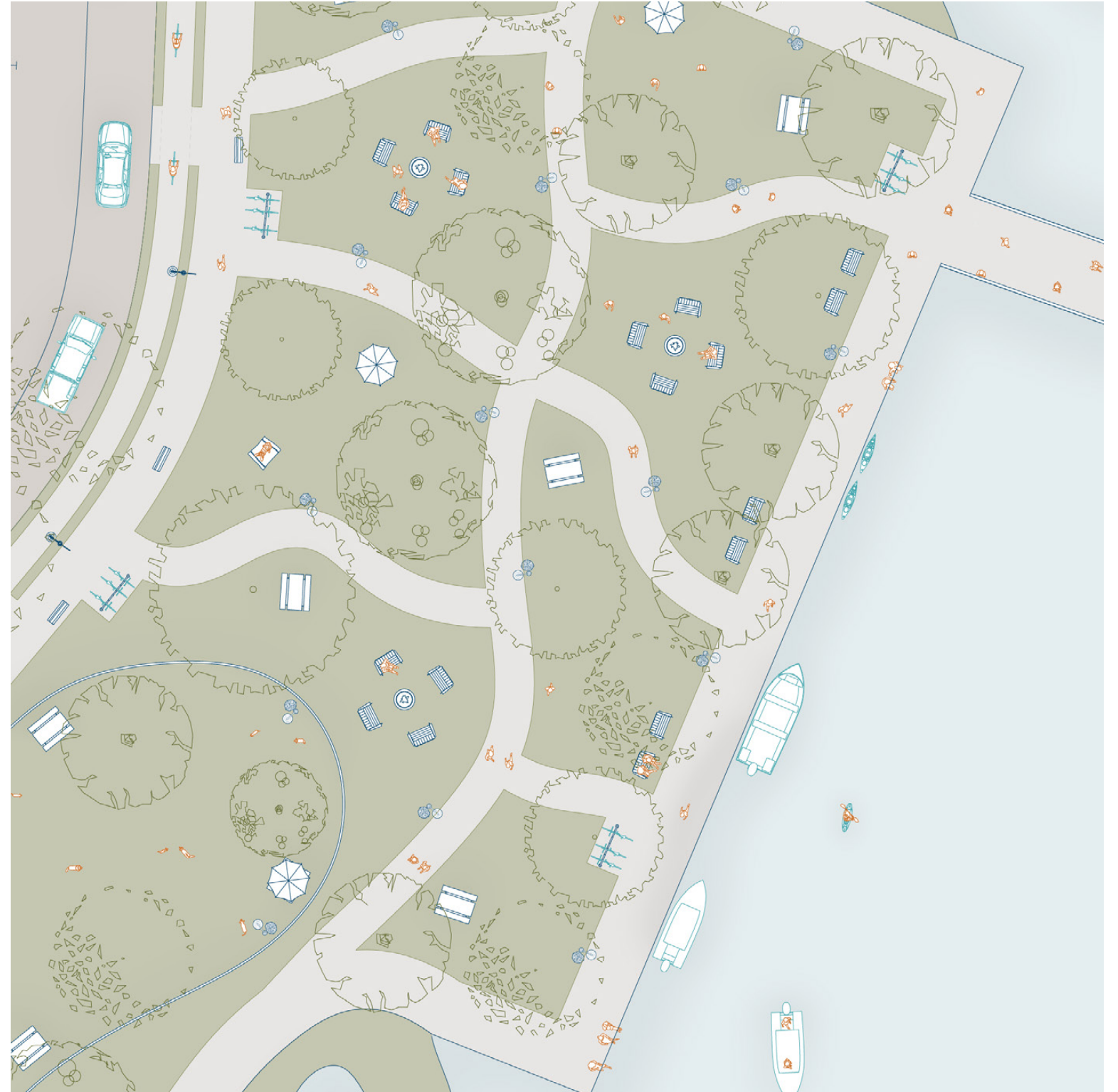
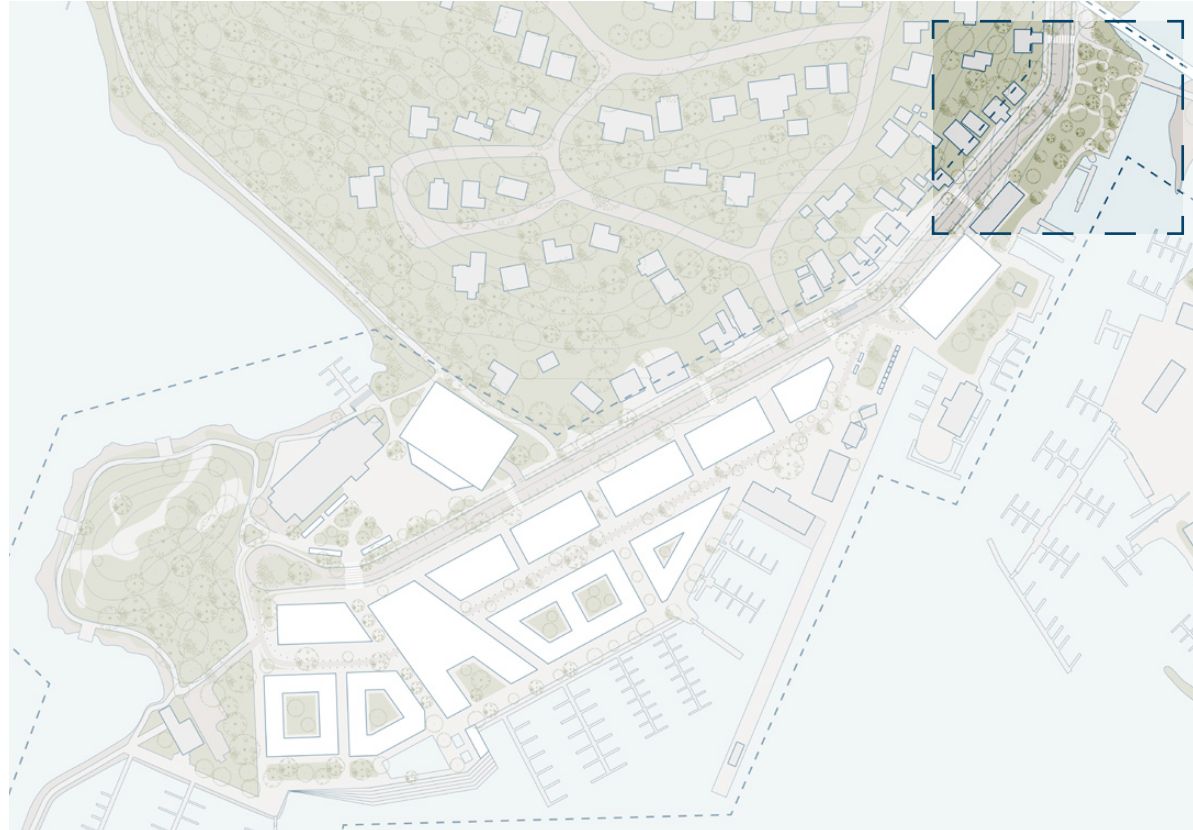

Trestle Park Site Section

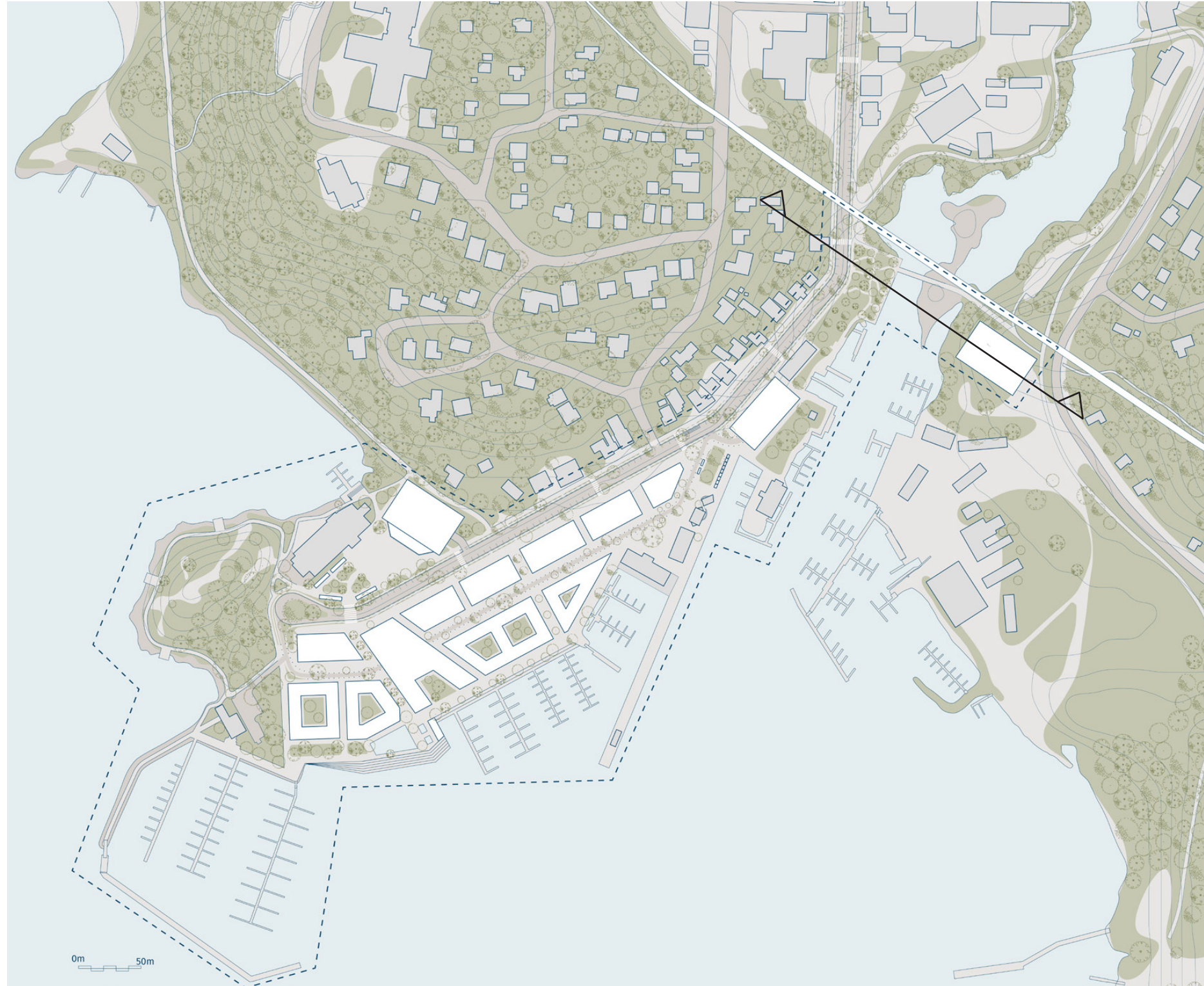

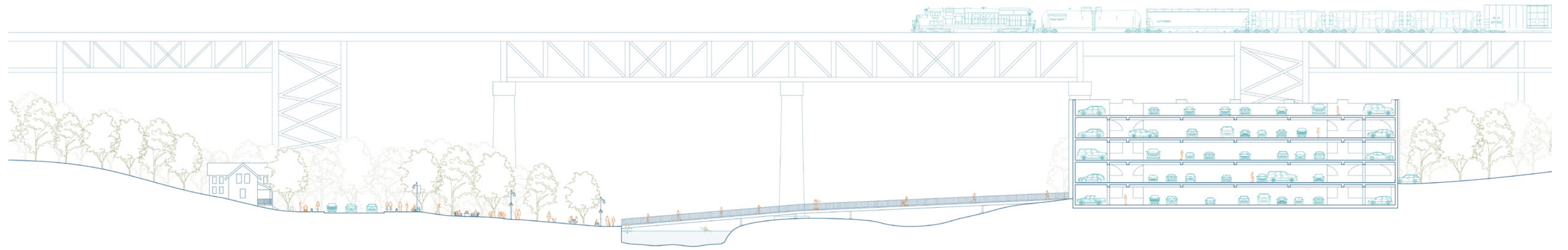

Trestle Park Site Section



Existing Single Family Homes

Trestle Park

Trestle Park Site Section



Trestle Park Site Section

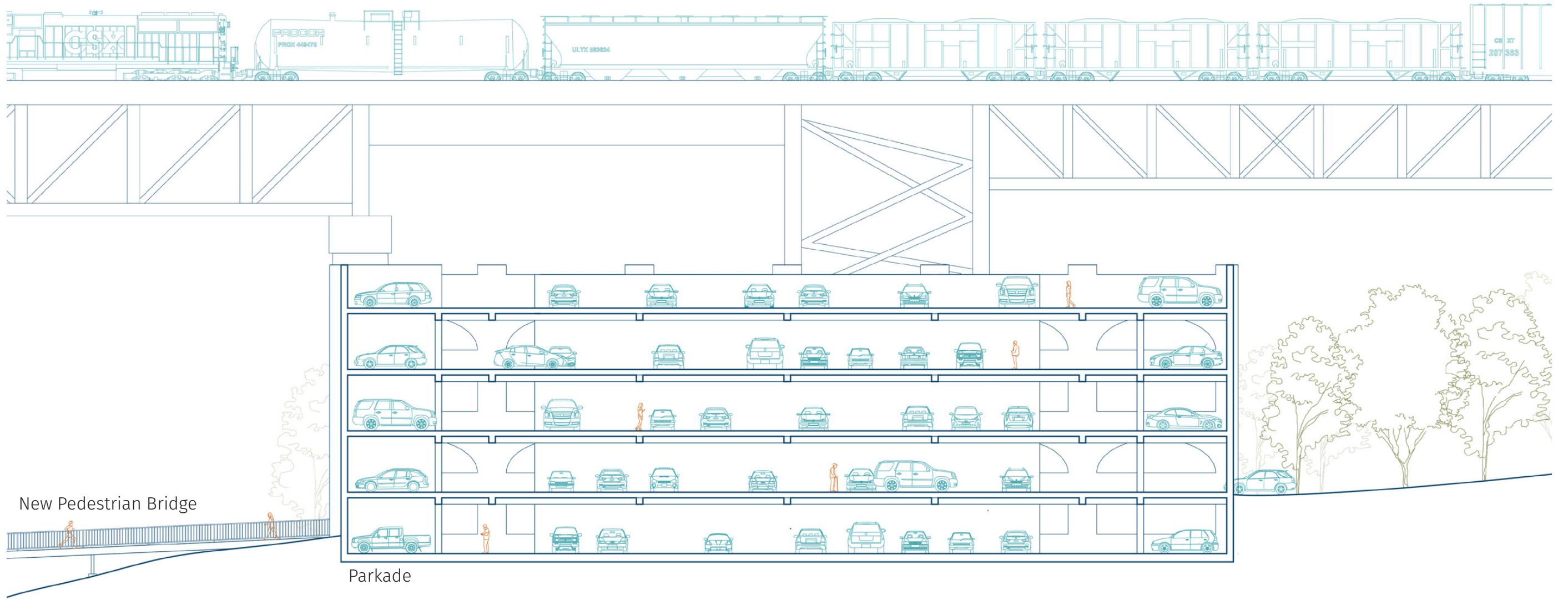

New Pedestrian Bridge

Parkade

Trestle Park Site Section

Dwelling Site Section

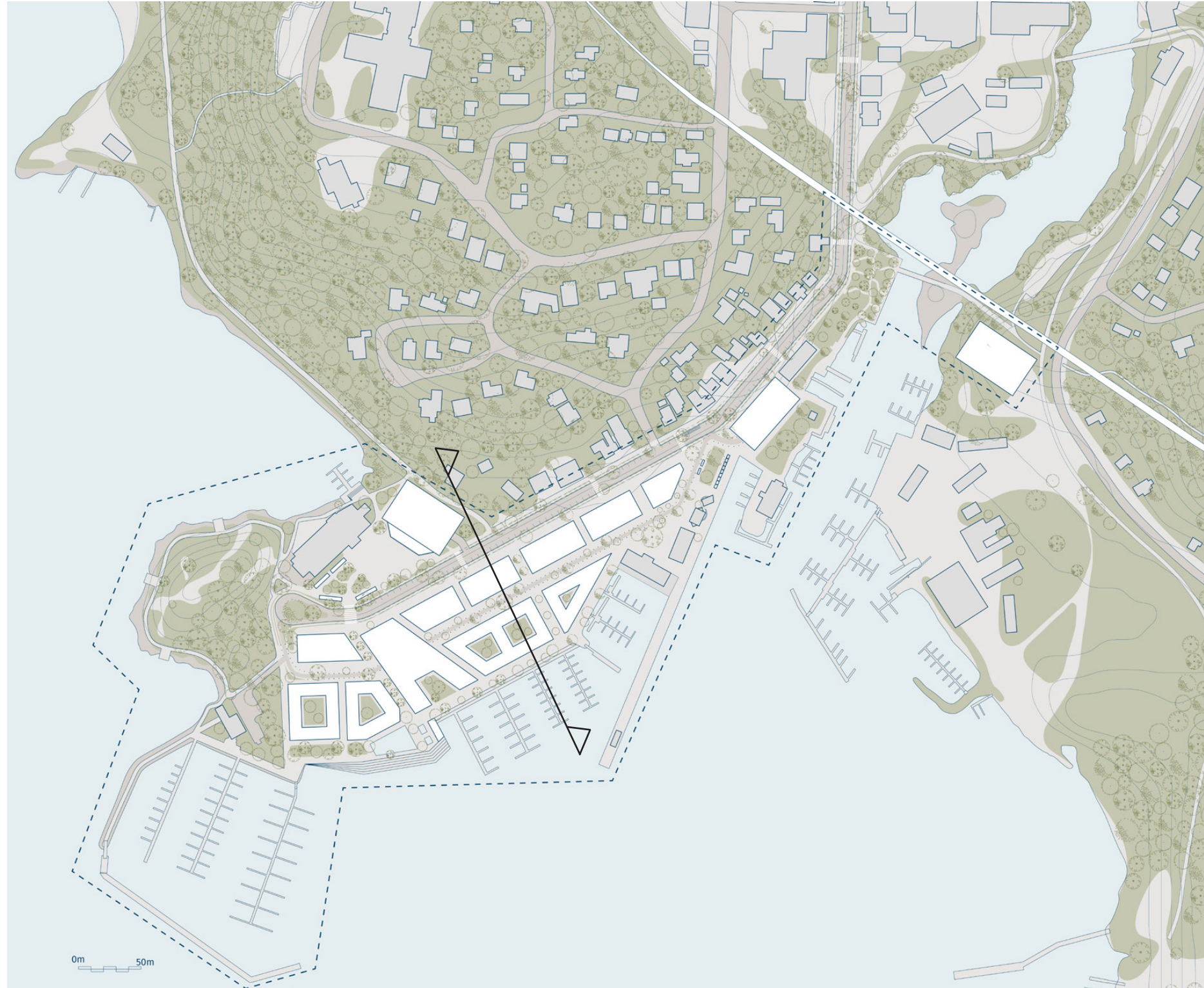



Dwelling Site Section



Dwelling Site Section

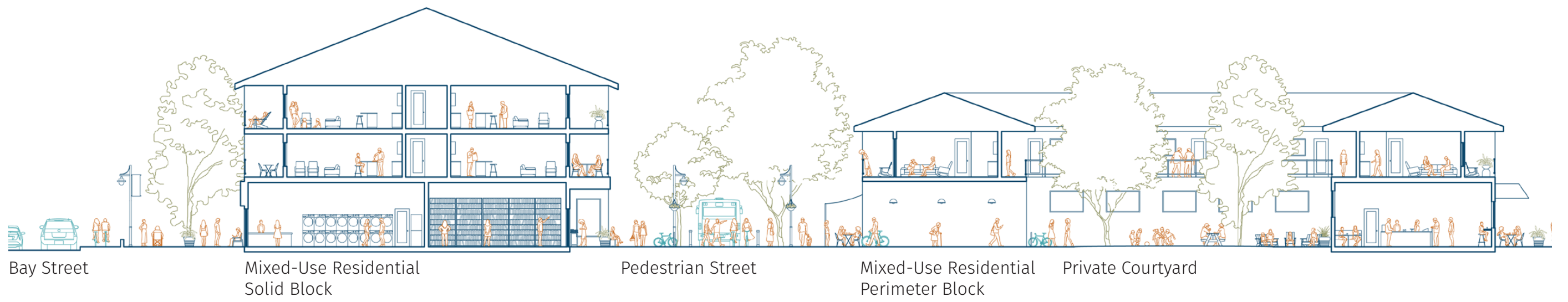

Bay Street

Mixed-Use Residential
Solid Block

Pedestrian Street

Mixed-Use Residential
Perimeter Block

Private Courtyard

Dwelling Site Section

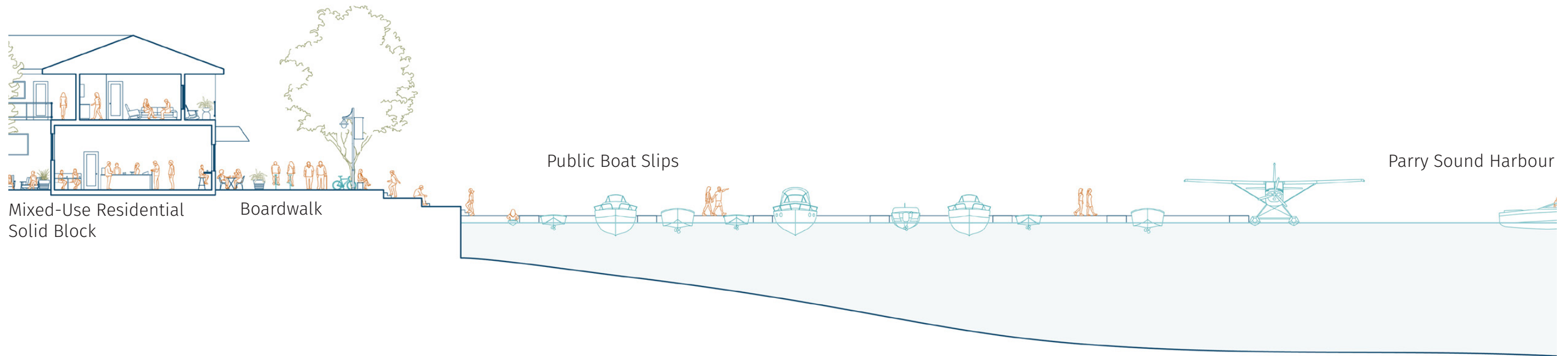

Mixed-Use Residential
Solid Block

Boardwalk

Public Boat Slips

Parry Sound Harbour

Dwelling Site Section



Neighbourhood Square and Hub Site Section

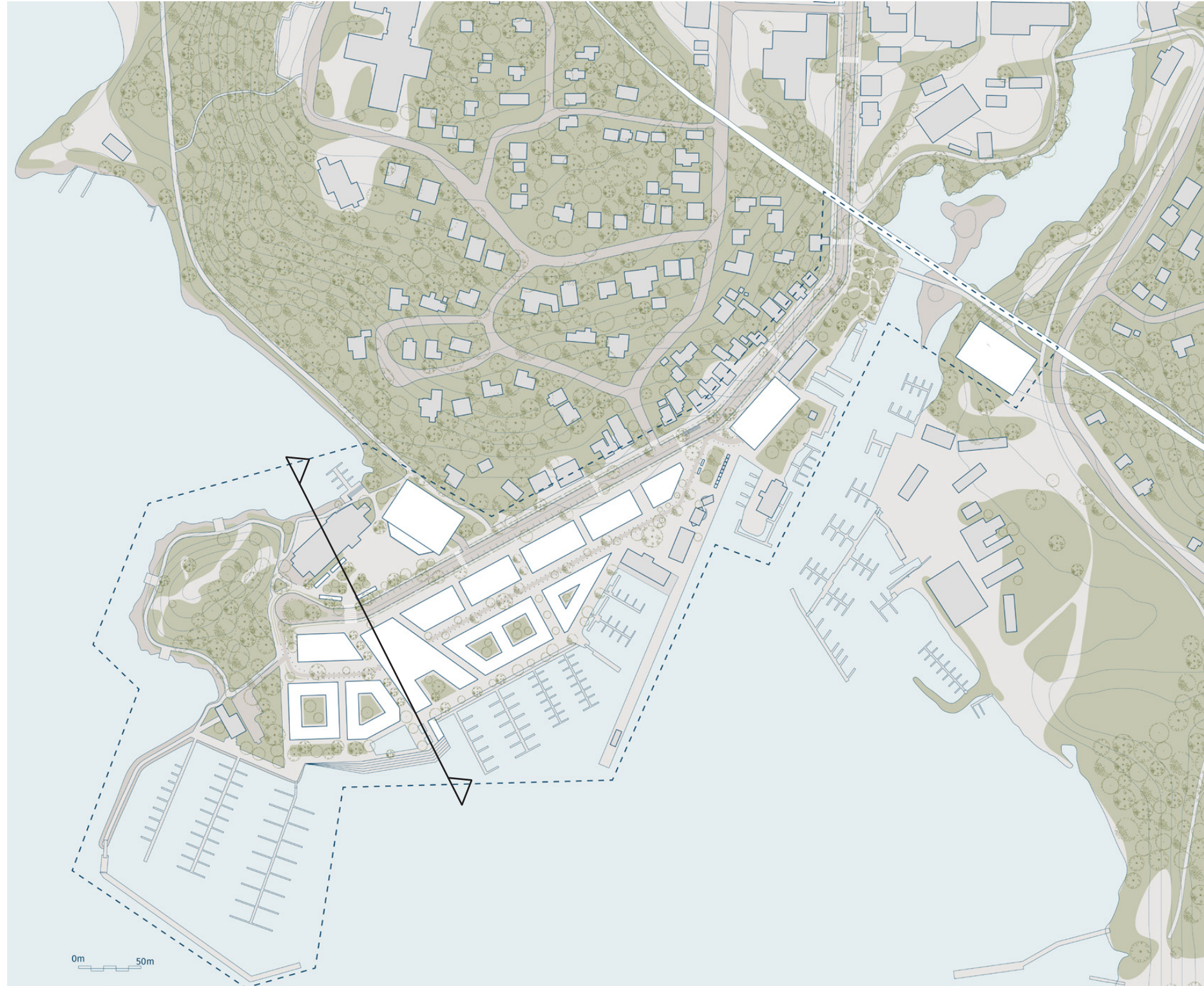



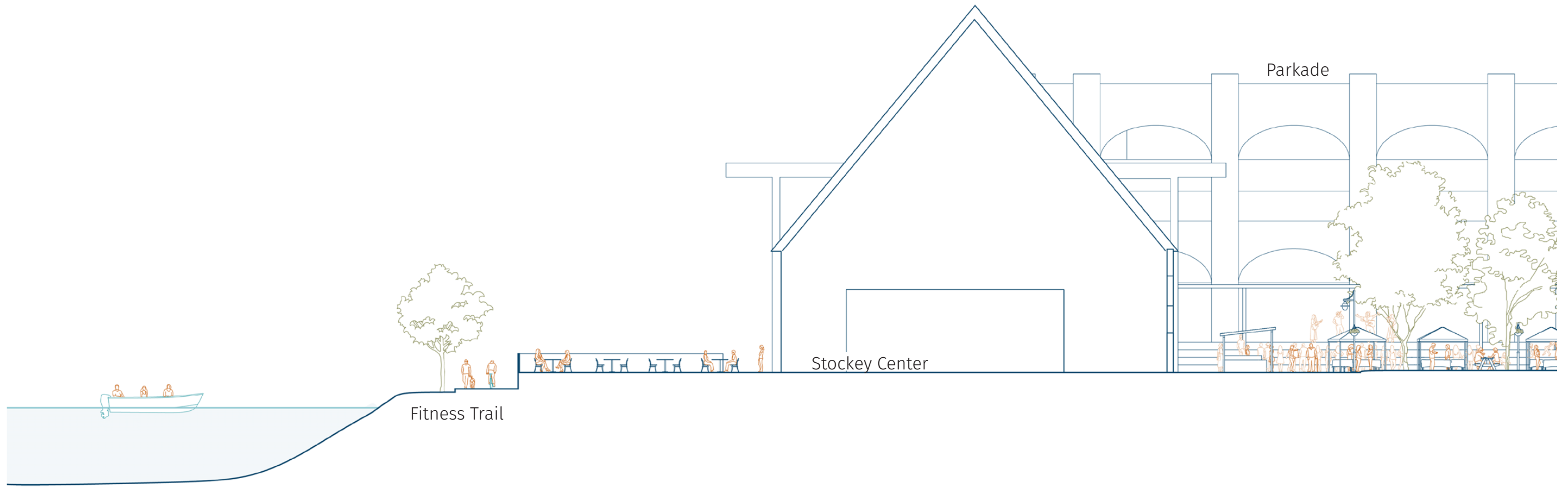

Neighbourhood Square and Hub Site Section

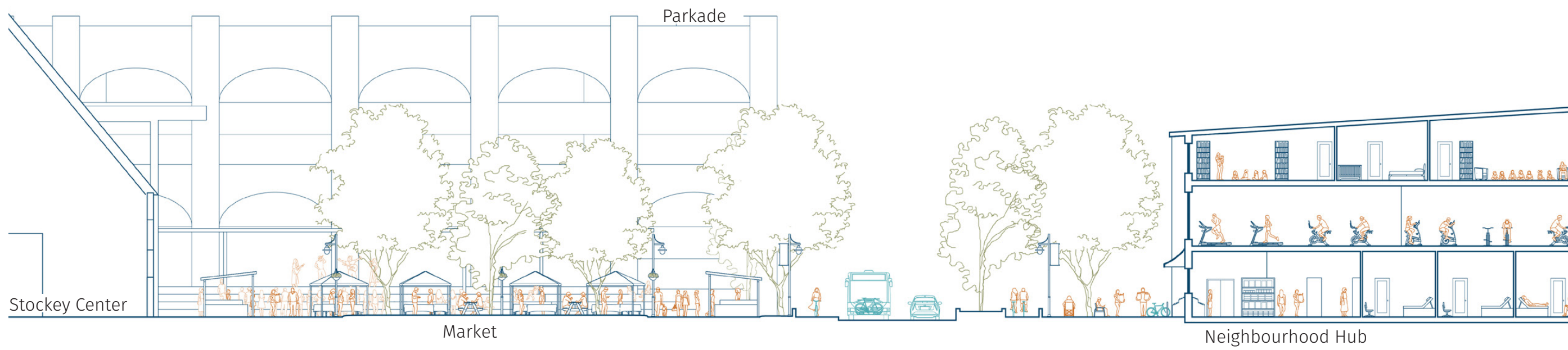

Neighbourhood Square and Hub Site Section

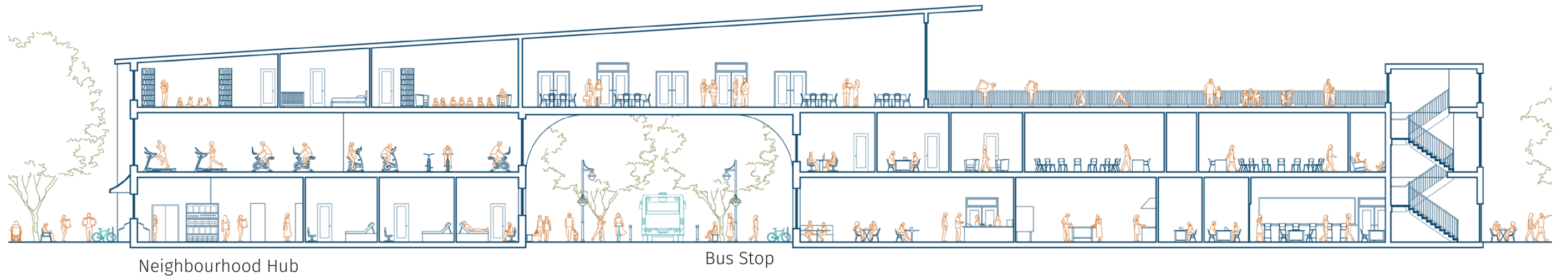

Neighbourhood Hub

Bus Stop

Neighbourhood Square and Hub Site Section

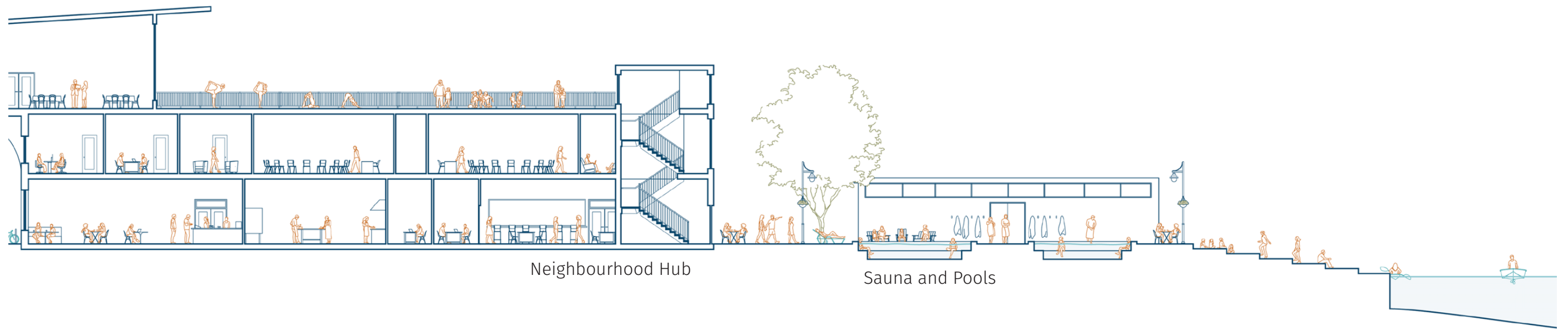

Neighbourhood Square and Hub Site Section



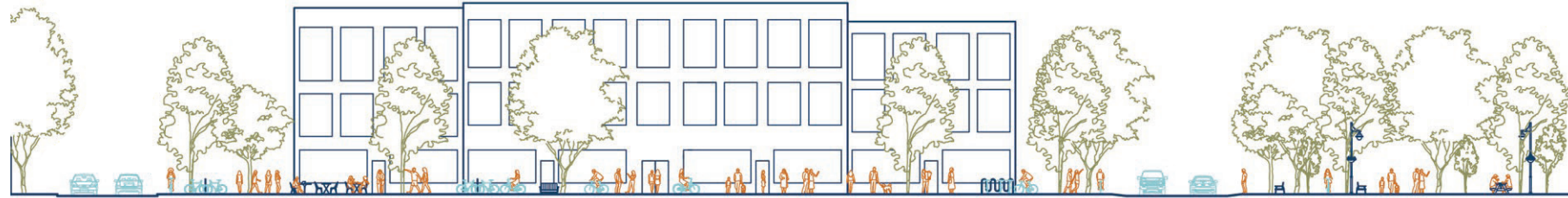

Thank You